

SPINNER

VC750

Performance Machining Centre



Machine Highlights

No operating elements at rear side of machine

Compact dimensions



Pivoting operating panel

Graphic dialogue programming as standard for small batch manufacturers

Latest control generation:

Heidenhain TNC620
Siemens 840D-SL
Fanuc 0i



Heidenhain TNC620

Optimal compact
Highly dynamic
High spindle speeds
Solid cast structure

**Solid
cast structure**

**Quick double arm changer
with 24 tool magazine**

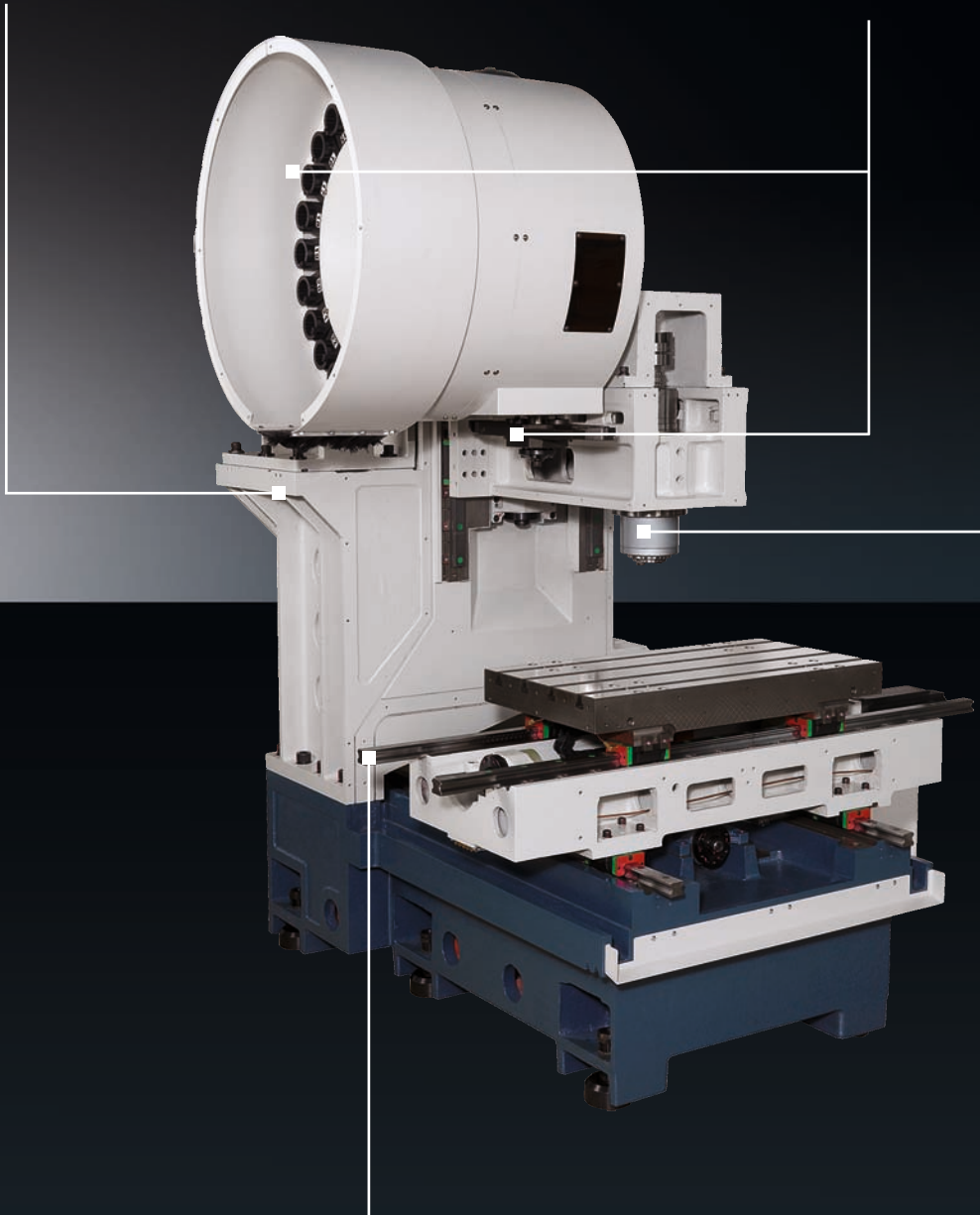

**Modern linear
guides in all axes
for high rapid
traverse**

**Inline-Spindle up to
15.000 rpm
SK40/BT40**

Working area			
X axis	760 mm		
Y axis	460 mm		
Z axis	460 mm		
Min. distance spindle nose - table surface	120 mm		
Max. distance spindle nose - table surface	580 mm		
Machining table			
Table dimensions	900 x 410 mm		
Max. table load	350 kg		
T-slots	16 x 4 x 100		
Axes			
Feed / rapid traverse	36 m/min		
Spindle			
Max. spindle speed	12.000 rpm		
Tool taper	SK40 (optional BT40/HSK63)		
Performance P _{max}	13 - 17 kW ¹⁾		
Torque M _{max}	83 - 108 Nm ¹⁾		
Tool magazine		Option	
Number of tool stations	24	32	
Max. tool diameter	80 mm	75 mm	
In case of free adjacent tool stations	125 mm	125 mm	
Max. tool length	300 mm	300 mm	
Max. tool weight	8 kg	7 kg	
General indications			
Dimensions (L x W x H)	2590 x 1700 x 2825 mm ²⁾		
Weight	ca. 3.700 kg ³⁾	ca. 4.000 kg ³⁾	

1) According to machine control; 2) See floor plan; 3) Machine net weight

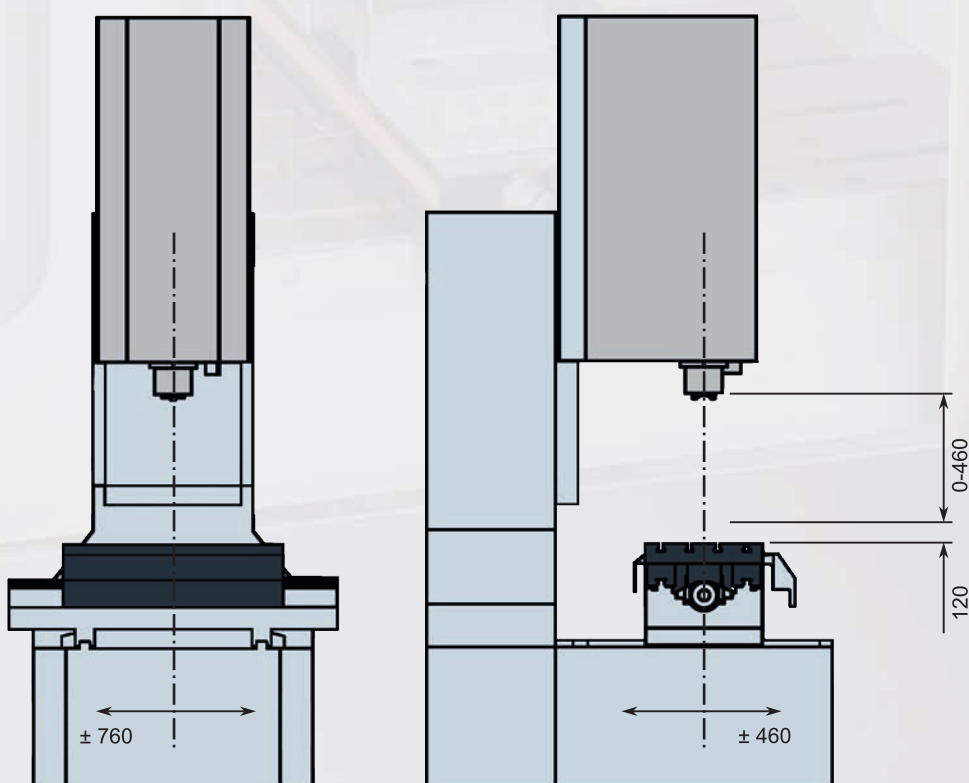

Siemens

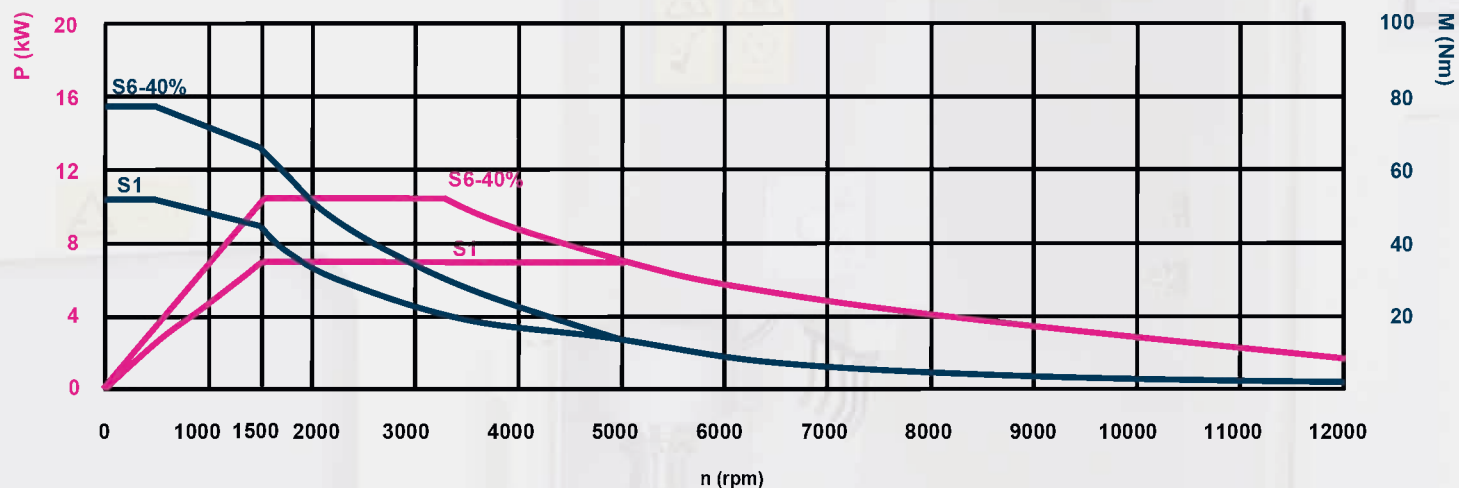

Heidenhain

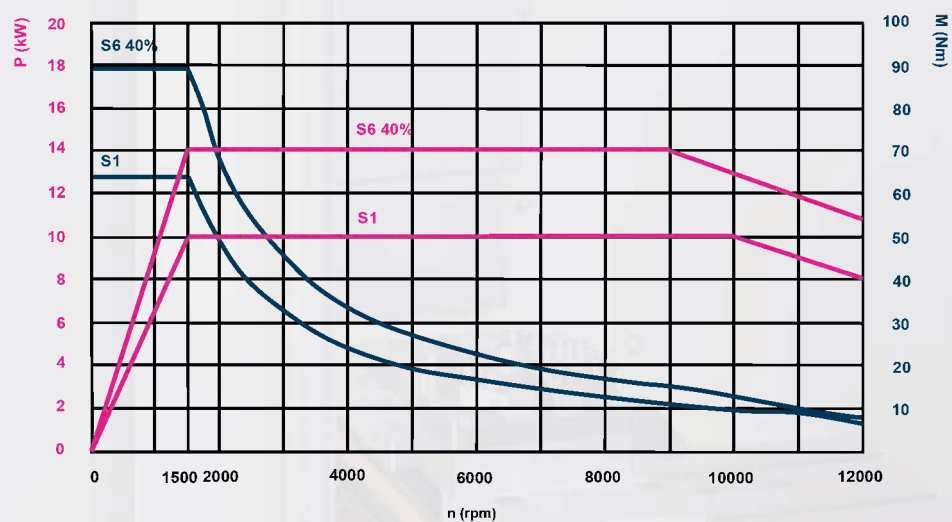

Fanuc

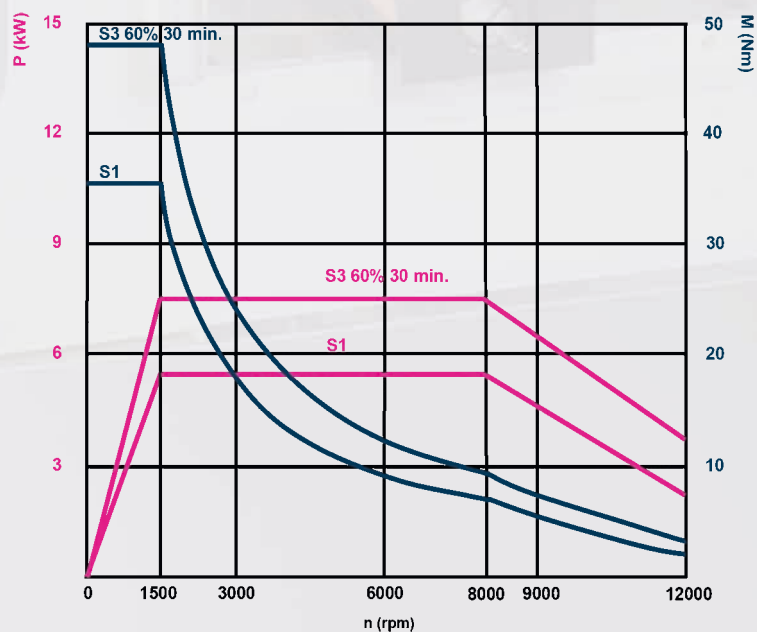

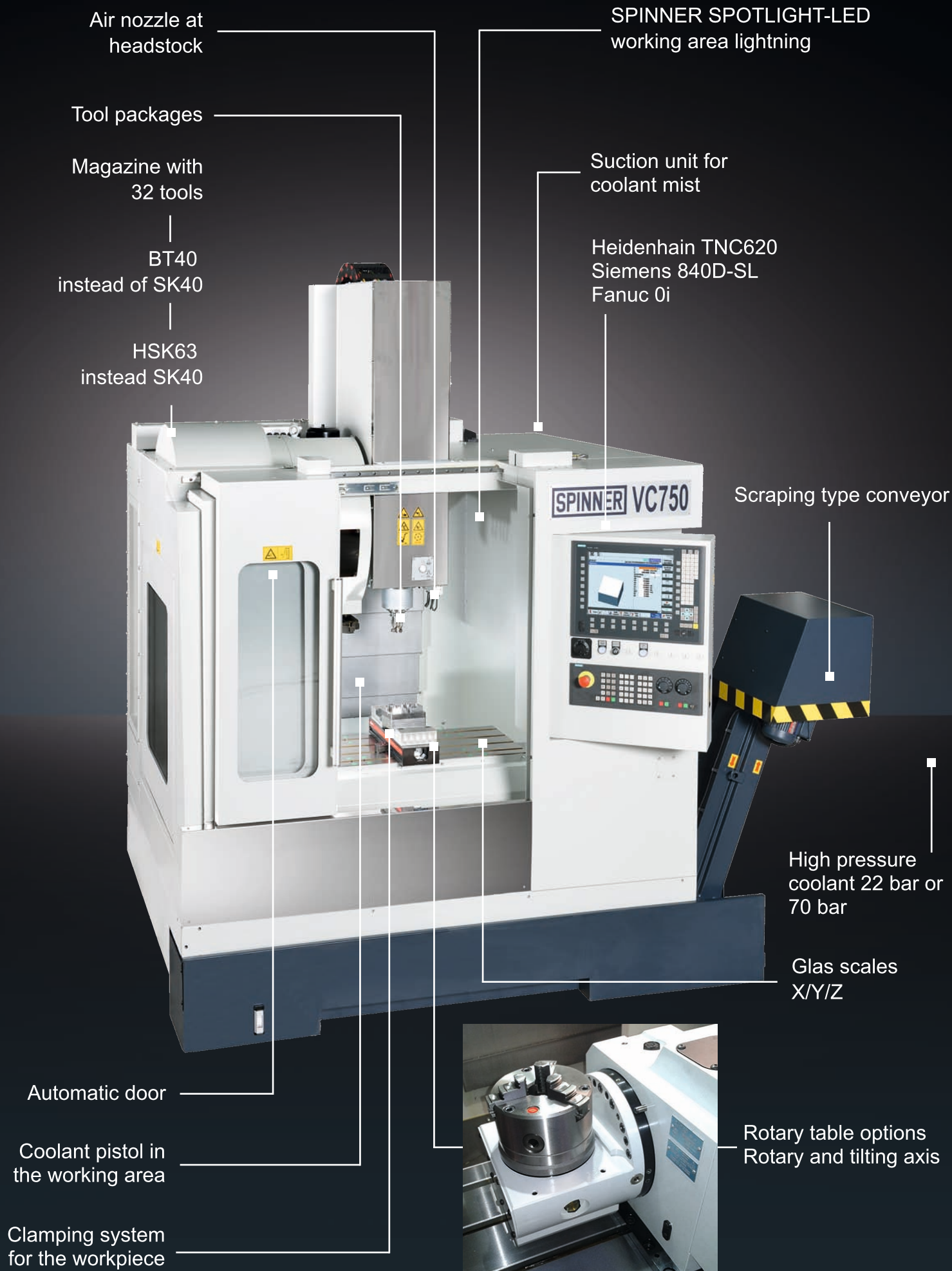

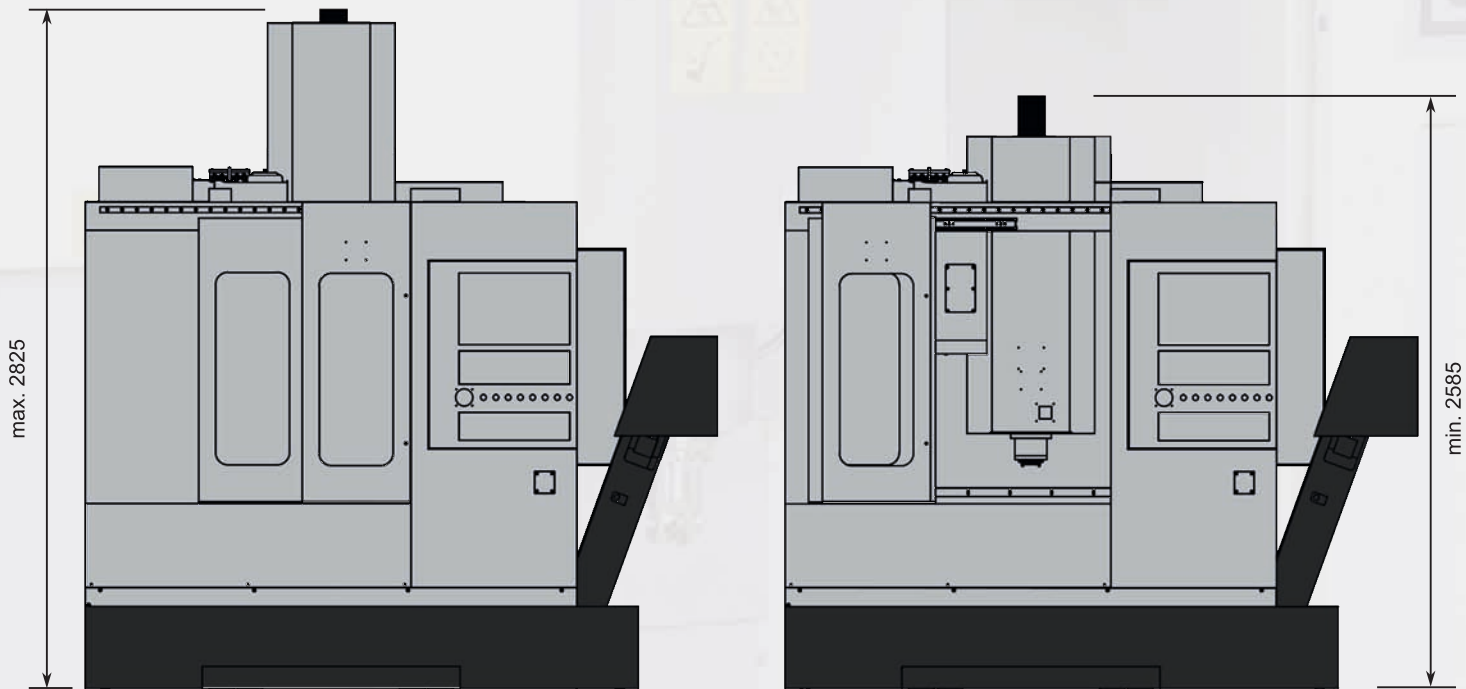



**Compact dimensions
for low space requirement**

**No operating elements at rear side of
machine
Thereby a space-saving installation is
possible**

 Only present in case of machine with
32 tool magazine option

 Version with standard
chip conveyor

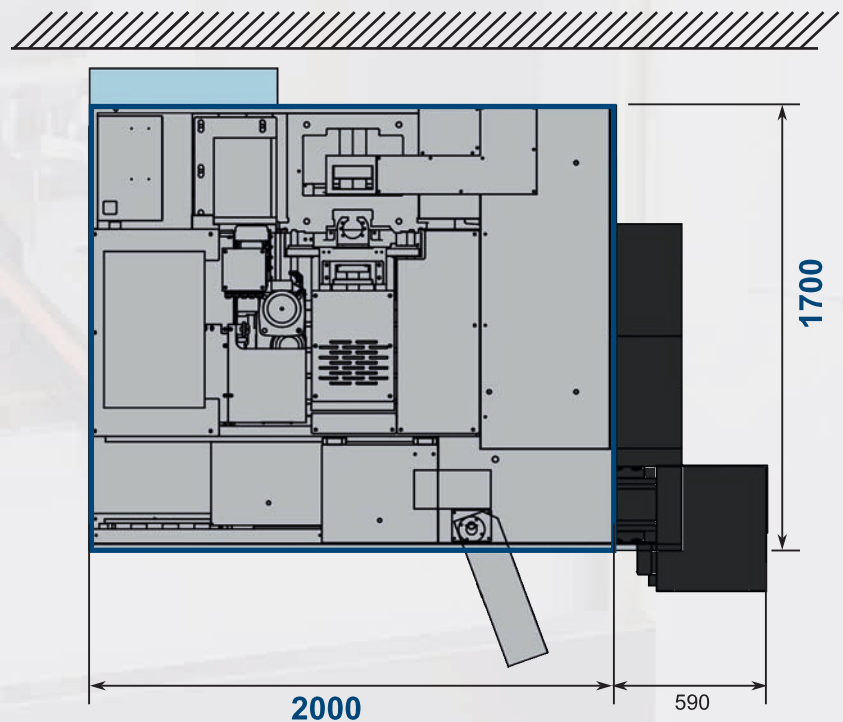



Werkzeugmaschinenfabrik GmbH



Spinner Machine-Tools are working successfully world wide with many well known clients in more than 60 countries on 6 continents. We have been fortunate enough to attract small component suppliers in addition to well known global groups in all metal machining industries.

We have designed and produced the most modern machine-tools since 1950. More than 20.000 delivered machines demonstrate their high efficiency, precision and reliability, everyday.

Although Spinner is a medium-sized enterprise we produce and sell more than 1.000 CNC machines a year. And the number is increasing every year. Our company combines the know-how of a global player with the flexibility and cost-effective structures of a family owned business.

Place your trust in our products as well and let us know what we can do for you.



Video

SPINNER Werkzeugmaschinenfabrik GmbH

Rudolf-Diesel-Ring 24

82054 Sauerlach

Tel. +49 (0) 8104 803-0

Fax +49 (0) 8104 803-19

sales@spinner.eu.com



Version 01/2015

Technical changes of specifications and pictures are subject to change without notice - Pictures can include options, accessories